

注：本板为禁止传输、复制、编辑、修改、以及用其内容进行交流

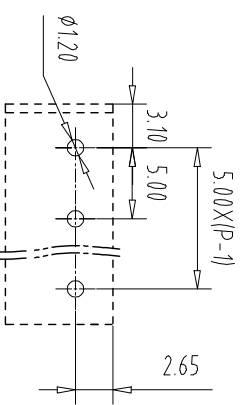
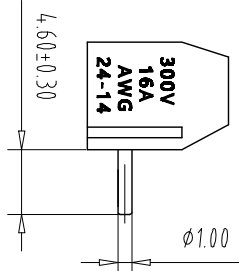
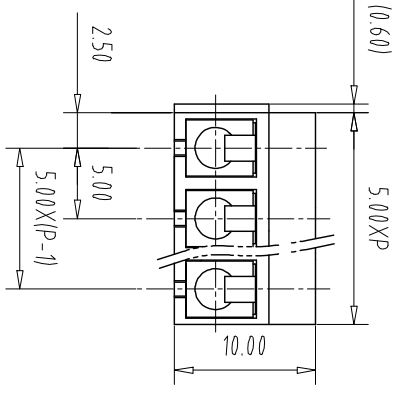
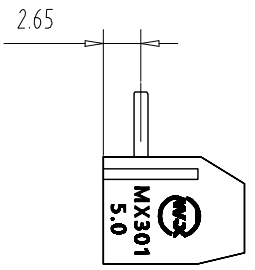
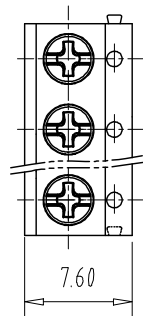

PCB Layout

Pitch	Range	In	Nominal Dimension	Range		
mm	Over 6	Over 10	Over 30	Over 60	Over 100	Over 150
	TO 6	TO 10	TO 30	TO 60	TO 100	TO 150
	±0.15	±0.20	±0.30	±0.50	±0.70	±1.00
						±1.30
						±2°

REV	ECN NO.	CONTENT	CHK	DATE

- NOTES1:
- UL Standard
 - 1.Rating voltage/current: 300V//16A
 - 2.withstanding voltage: AC2000V//1Min
 - 3.Torque value: M2.5, 3.54Lbin
 - 4.Wire range: 24~14AWG
- IEC Standard

Pollution Degree	3	2	2
Overvoltage Category	III	II	II
Rate Impulse Voltage(KV)	/	/	/
Rate Voltage(V)	/	250V	/
Rate Current(A)	/	17.5A	/

- NOTES2:
- 1.Housing: PA66(UL94V-0)
 - 2.Solder Pin: Copper alloy(Sn Plated)
 - 3.Spring: Stainless Steel
 - 4.Screw: Steel(M2.5,Zn Plated)

- NOTES3:
- 1.Pitch: 5.0mm Poles: 02-22P
 - 2.Stripping length: 6-7mm
 - 3.Operating temperature: -40℃~+105℃
 - 4.RoHS Compliance

How to order

MX301R - 5.0 - XXP - XXXX - XX - X - X

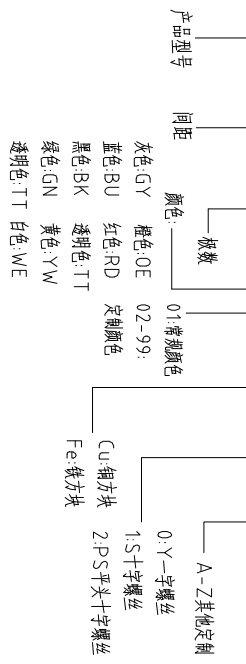

ITEM	NAME OF PART	NO. OF PART	Q'TY	MATERIAL	NOTE
DWG	CHK	DATE	SCALE	SHEET/OF	1/1
APP	DATE	SCALE	1:1	A4	1/1
CIXI MAIXU ELECTRONICS CO.,LTD			NAME		
MAIXU 慈溪市迈旭电子有限公司			MX301R-5.0-XXP		
DWGNO.			DWGNO.		