

Fig1. MEASURING METHOD

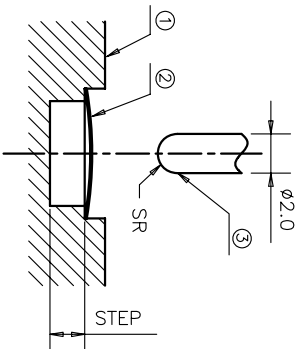

Fig2. OPERATING PERFORMANCE

NOTES:  
 1. ALL THE OPERATING PERFORMANCE SPEC. IN BELLOW TABLE SHOULD BE MET. THE MEASURE METHOD IS SHOWN AS FIG.1. OPERATE THE DOME 10 TIMES BEFORE MEASURING.

| REV | ECON NO. | APPD |
|-----|----------|------|
| A   | HC060009 | ZO   |
| B   | HC060033 | ZO   |
| C   | HC100168 | ZO   |
| D   | HC110001 | ZO   |
| E   | HC140005 | ZO   |
| F   | HC160002 | ZO   |

$F_p$ : PEAK FORCE  
 $F_r$ : RETURN FORCE  
 T1: CONTACT POINT  
 T2: BUTTON POINT  
 $C/R=(F_p-F_r)/F_p *100\%$   
 REMARK:  
 1. T2 TESTED WHEN THE SETP IS DEEP ENOUGH TO NOT CONTACT WITH DOME DURING MEASURING.  
 2.  $T1 < T2$

- 1) TEST SPEED : 120 SPM
- 2) TEST FORCE :  $F_p$
- 3) MATERIAL : ALUMINUM.
2. OBVIOUS BURR, SCRATCHES, CRACKES IS FORBIDDEN.
3. DIMENSIONS MARKED  $\nabla$  SHOULD BE CHECKED BY Q.C. AND P.E.
4. DIMENSIONING SHALL BE INTERPRETED PER ANSI Y14.5M-1982.
5. HARMFUL MATERIAL CONTROL PLEASE FOLLOW DOC."HY-QW-02"
6. PART PERFORMANCE TABLE  $\nabla$

| PART NAME     | D                   | H         | P.F(gf) | C/R(%) |
|---------------|---------------------|-----------|---------|--------|
| 600-5***-**** | $\phi 5^{+0.05}$    | 0.25±0.05 | CP±15   | C/R±10 |
| 600-C***-**** | $\phi 4.5^{+0.05}$  | 0.22±0.05 | CP±15   | C/R±10 |
| 600-4***-**** | $\phi 4^{+0.05}$    | 0.2±0.05  | CP±15   | C/R±10 |
| 600-B***-**** | $\phi 3.5^{+0.05}$  | 0.18±0.05 | CP±15   | C/R±10 |
| 600-3***-**** | $\phi 3^{+0.05}$    | 0.16±0.05 | CP±15   | C/R±10 |
| 600-L***-**** | $\phi 2.92^{+0.02}$ | 0.15±0.05 | CP±15   | C/R±10 |
| 600-J***-**** | $\phi 2.9^{+0.05}$  | 0.15±0.05 | CP±15   | C/R±10 |
| 600-K***-**** | $\phi 2.85^{+0.02}$ | 0.15±0.05 | CP±15   | C/R±10 |
| 600-A***-**** | $\phi 2.5^{+0.05}$  | 0.15±0.05 | CP±15   | C/R±10 |
| 600-D***-**** | $\phi 2.2^{+0.05}$  | 0.15±0.05 | CP±15   | C/R±10 |
| 600-2***-**** | $\phi 2.0^{+0.05}$  | 0.15±0.05 | CP±15   | C/R±10 |

| TYPE: | DIMPLE: | D:        | C/R:  | STEP:    | MATERIAL: | CP:       |
|-------|---------|-----------|-------|----------|-----------|-----------|
| 601   | 01345   | 2=φ2.0mm  | 0=60% | 0=0.00mm | 9=SUS     | 060=060gf |
| 01    | 1345    | 3=φ3.0mm  | 1=65% | 1=0.01mm | 0=NI-SUS  | 080=080gf |
| 1     | 1345    | 4=φ4.0mm  | 2=55% | 2=0.02mm | S=AG-SUS  | 100=100gf |
| :     | 1345    | 5=φ5.0mm  | 3=45% | 3=0.03mm | 1=PB      | 130=130gf |
| :     | 1345    | 6=φ6.0mm  | 4=35% | 4=0.04mm | 2=BECU    | 160=160gf |
| :     | 1345    | A=φ2.5mm  | 5=25% | 5=0.05mm |           | 180=180gf |
| :     | 1345    | B=φ3.5mm  | 6=15% | 6=0.06mm |           | 200=200gf |
| :     | 1345    | C=φ4.5mm  |       | 7=0.07mm |           | 250=250gf |
| :     | 1345    | D=φ2.2mm  |       | 8=0.08mm |           |           |
| :     | 1345    | E=φ2.3mm  |       | 9=0.09mm |           |           |
| :     | 1345    | F=φ2.4mm  |       | A=0.10mm |           |           |
| :     | 1345    | G=φ2.7mm  |       |          |           |           |
| :     | 1345    | H=φ2.8mm  |       |          |           |           |
| :     | 1345    | J=φ2.9mm  |       |          |           |           |
| :     | 1345    | K=φ2.85mm |       |          |           |           |
| :     | 1345    | L=φ2.92mm |       |          |           |           |

| X ± 0.2     | X' ± 3'      | UNITS | FINISH | NAME(INTENDED USE)               | CHKD:  | DR:   | SCALE | SHEET | REV. |
|-------------|--------------|-------|--------|----------------------------------|--------|-------|-------|-------|------|
| .X ± 0.1    | X' ± 2'      | MM    | MAT'L  | METAL DOME FOR TACT SWITCH       | M.H.LI | WP.LU | 1/1   | 1/5   | F    |
| .XX ± 0.05  | .XX' ± 1'    |       |        |                                  |        |       |       |       |      |
| .XXX ± 0.03 | .XXX' ± 0.5' |       |        |                                  |        |       |       |       |      |
|             |              |       |        | PART NO.(INTENDED USE)           |        |       |       |       |      |
|             |              |       |        | 600-****-****                    |        |       |       |       |      |
|             |              |       |        | APPD: ZO 3/18/2014               |        |       |       |       |      |
|             |              |       |        | NAME(INTENDED USE)               |        |       |       |       |      |
|             |              |       |        | HON YUAN                         |        |       |       |       |      |
|             |              |       |        | DOME CUSTOMER DRAWING            |        |       |       |       |      |
|             |              |       |        | NAME(INTENDED USE)               |        |       |       |       |      |
|             |              |       |        | HON YUAN PRECISION IND. CO.,LTD. |        |       |       |       |      |
|             |              |       |        | SHENZHEN, CHINA, R.O.C.          |        |       |       |       |      |
|             |              |       |        | DWG NO.:                         |        |       |       |       |      |
|             |              |       |        | 600-0000-000                     |        |       |       |       |      |

1 2 3 4 5 6

D C B A