

NOTES:
1. ALL THE OPERATING PERFORMANCE SPEC. IN BELLOW TABLE SHOULD BE MET. THE MEASURE METHOD IS SHOWN AS FIG.1.
OPERATE THE DOME 10 TIMES BEFORE MEASURING.

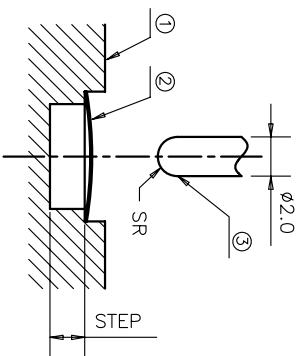
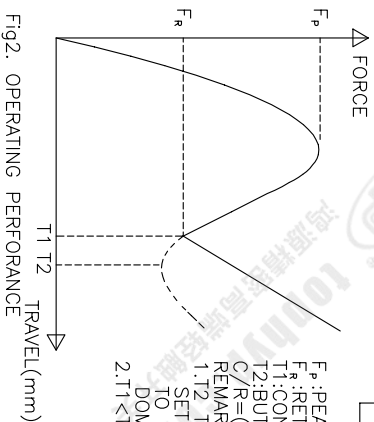

Fig1. MEASURING METHOD



F_p: PEAK FORCE
F_r: RETURN FORCE
T1: CONTACT POINT
T2: BUTTON POINT
C/R=(F_p-F_r)/F_p*100%
REMARK:
1. T2 TESTED WHEN THE SETP IS DEEP ENOUGH TO NOT CONTACT WITH DOME DURING MEASURING.
2. T1<T2

REV	ECON NO.	APPD
A	HC060009	ZO
B	HC060033	ZO
C	HC100168	ZO
D	HC110001	ZO
E	HC140005	ZO
F	HC160002	ZO

- 1) TEST SPEED : 120 SPM
- 2) TEST FORCE : F_p
- 3) MATERIAL : ALUMINIUM.
2. OBVIOUS BURR, SCRATCHES, CRACKES IS FORBIDDEN.
3. DIMENSIONS MARKED √ SHOULD BE CHECKED BY Q.C. AND P.E.
4. DIMENSIONING SHALL BE INTERPRETED PER ANSI Y14.5M-1982.
5. HARMFUL MATERIAL CONTROL PLEASE FOLLOW DOC."HY-QW-02"
6. PART PERFORMANCE TABLE √

PART NAME	D	H	P.F(gf)	C/R(%)
600-5***-****	∅5 ^{+0.05} _{-0.05}	0.25±0.05	CP±15	C/R±10
600-C***-****	∅4.5 ^{+0.05} _{-0.05}	0.22±0.05	CP±15	C/R±10
600-4***-****	∅4 ^{+0.05} _{-0.05}	0.2±0.05	CP±15	C/R±10
600-B***-****	∅3.5 ^{+0.05} _{-0.05}	0.18±0.05	CP±15	C/R±10
600-3***-****	∅3 ^{+0.05} _{-0.05}	0.16±0.05	CP±15	C/R±10
600-L***-****	∅2.92 ^{+0.02} _{-0.02}	0.15±0.05	CP±15	C/R±10
600-J***-****	∅2.9 ^{+0.05} _{-0.05}	0.15±0.05	CP±15	C/R±10
600-K***-****	∅2.85 ^{+0.02} _{-0.02}	0.15±0.05	CP±15	C/R±10
600-A***-****	∅2.5 ^{+0.05} _{-0.05}	0.15±0.05	CP±15	C/R±10
600-D***-****	∅2.2 ^{+0.05} _{-0.05}	0.15±0.05	CP±15	C/R±10
600-2***-****	∅2.0 ^{+0.05} _{-0.05}	0.15±0.05	CP±15	C/R±10

TYPE:	DIMPLE:	D:	C/R:	STEP:	MATERIAL:	CP:
60111	01345	2=∅2.0mm	0=60%	0=0.00mm	9=SUS	060=060gf
01111	11345	3=∅3.0mm	1=65%	1=0.01mm	0=NI-SUS	080=080gf
01111	11345	4=∅4.0mm	2=55%	2=0.02mm	S=AG-SUS	100=100gf
01111	11345	5=∅5.0mm	3=45%	3=0.03mm	1=PB	130=130gf
01111	11345	6=∅6.0mm	4=35%	4=0.04mm	2=BECU	160=160gf
01111	11345	A=∅2.5mm	5=25%	5=0.05mm		180=180gf
01111	11345	B=∅3.5mm	6=15%	6=0.06mm		200=200gf
01111	11345	C=∅4.5mm		7=0.07mm		250=250gf
01111	11345	D=∅2.2mm		8=0.08mm		
01111	11345	E=∅2.3mm		9=0.09mm		
01111	11345	F=∅2.4mm		A=0.10mm		
01111	11345	G=∅2.7mm				
01111	11345	H=∅2.8mm				
01111	11345	J=∅2.9mm				
01111	11345	K=∅2.85mm				
01111	11345	L=∅2.92mm				

X ± 0.2	X' ± 3'	UNITS	MM	NAME(INTENDED USE)	HON YUAN
.X ± 0.1	X' ± 2'	MAT'L		METAL DOME FOR TACT SWITCH	HON YUAN PRECISION IND. CO.,LTD.
.XX ± 0.05	.XX' ± 1'	FINISH			SHENZHEN, CHINA, R.O.C.
.XXX ± 0.03	.XXX' ± 0.5'				
THESE DIMENSIONS AND SPECIFICATIONS ARE THE PROPERTY OF HON YUAN PRECISION IND. CO., LTD. AND SHALL NOT BE REPRODUCED, COPIED OR USED IN ANY MANNER WITHOUT THE PRIOR WRITTEN CONSENT OF HON YUAN PRECISION IND. CO., LTD.				QTY	
APPD: ZO 3/18/2014				PART NO.(INTENDED USE)	600-****-****
CHKD: M.H.LI 3/18/2014				TITLE:	HOME CUSTOMER DRAWING
DR: WP.LU 3/18/2014				DWG NO.:	600-0000-000
SCALE SHEET		REV.			
1/1	1/5	F			